

INSTALLATION

FALSE MANHOLE BOTTOM SHALL BE FURNISHED AND INSTALLED IN ALL MANHOLES CONSTRUCTED IN ADVANCE OF PAVING OR IN ADVANCE OF PROPERTY DEMOLITION. THESE FALSE MANHOLE BOTTOMS WILL BE INSTALLED AT A TIME DIRECTED BY THE ENGINEER BUT WILL USUALLY BE AFTER ALL WORK IS COMPLETED ON THE WASTEWATER SYSTEM INCLUDING THE AIR TEST, BUT PRIOR TO THE FINAL INSPECTION.

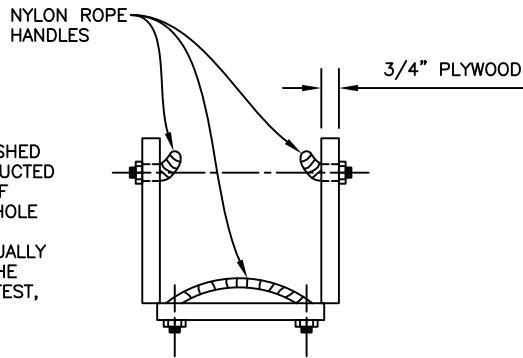

REMOVAL

FALSE MANHOLE BOTTOM SHALL BE REMOVED AFTER THE FINAL APPURTENANCE ADJUSTMENT INSPECTION. THE PAVING CONTRACTOR AND OWNER'S REPRESENTATIVE WILL COORDINATE THE REMOVAL OF THE FALSE MANHOLE BOTTOMS. CONTRACTOR SHALL REMOVE DEBRIS CAUGHT ON THE FALSE BOTTOM AND NOT ALLOW IT TO DROP INTO MANHOLE.

INSTALLATION AND REMOVAL POSITION

NOT TO SCALE

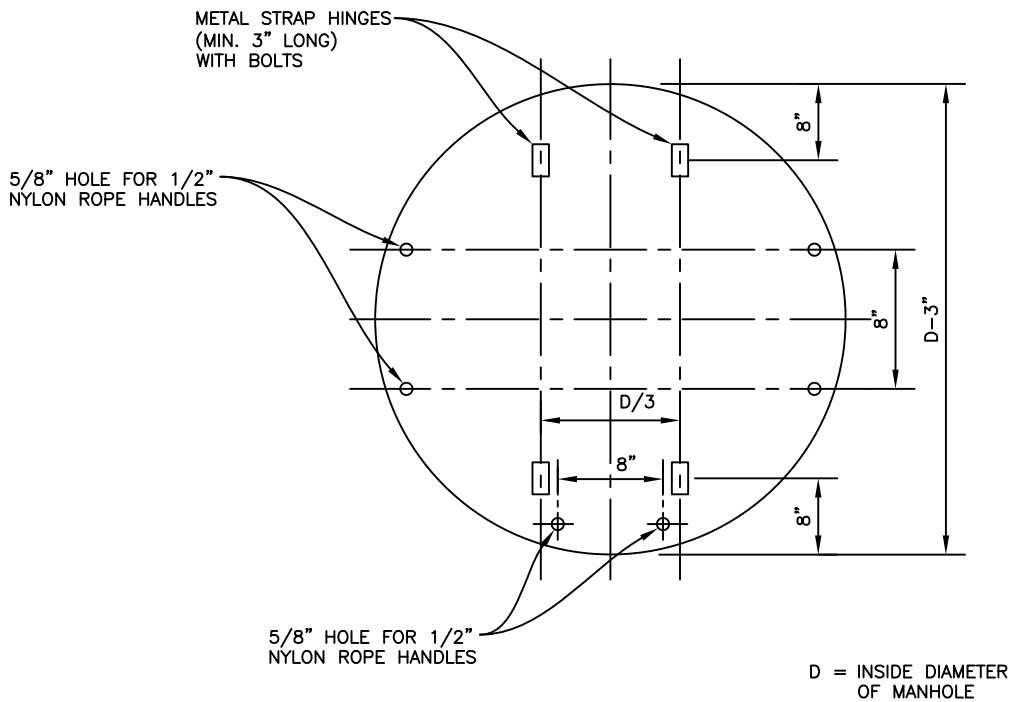

PLAN VIEW

NOT TO SCALE

Dublin San Ramon Services District	DATE DEC 2019
MANHOLE: FALSE BOTTOM	DESIGNED RM
SIGNED COPY ON FILE AT DISTRICT OFFICE	DRAWING S-16